

GEOGRID PLACEMENT FOR CONCAVE CURVES AND CORNERS

NOTE:

EXTEND REINFORCEMENT BEYOND END OF WALL BY AT LEAST H/4 (ONE QUARTER OF THE WALL HEIGHT). ALTERNATE WHICH SIDE IS EXTENDED EVERY OTHER COURSE OF GEOGRID AS SHOWN.

DETAILS SHOWN BASED ON FIGURE 13-1 FROM DESIGN MANUAL FOR SEGMENTAL RETAINING WALLS, THIRD EDITION, COPYRIGHT 2009, NATIONAL CONCRETE MASONRY ASSOCIATION, HERNDON, VA

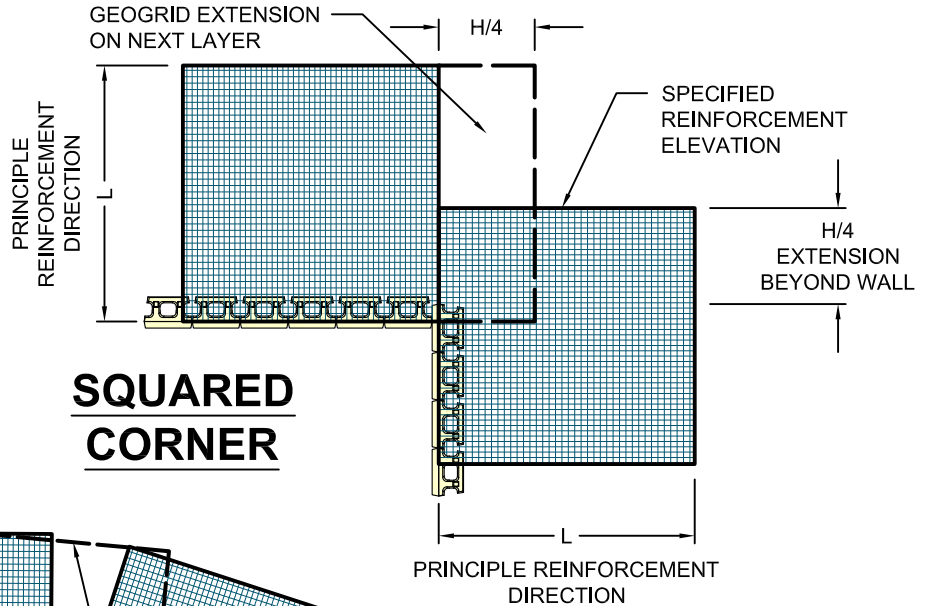

SQUARED CORNER

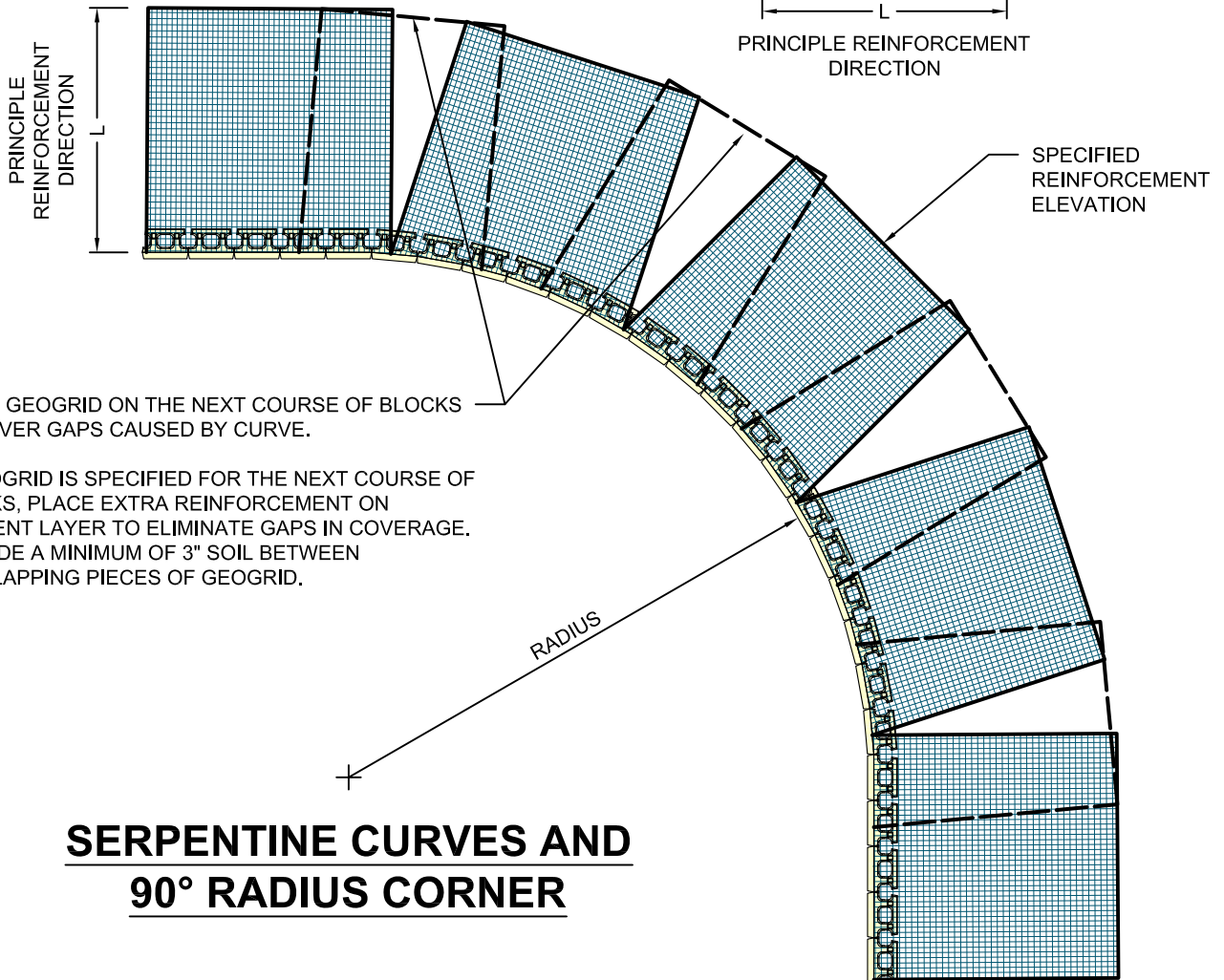

PLACE GEOGRID ON THE NEXT COURSE OF BLOCKS TO COVER GAPS CAUSED BY CURVE.

IF GEOGRID IS SPECIFIED FOR THE NEXT COURSE OF BLOCKS, PLACE EXTRA REINFORCEMENT ON CURRENT LAYER TO ELIMINATE GAPS IN COVERAGE. PROVIDE A MINIMUM OF 3" SOIL BETWEEN OVERLAPPING PIECES OF GEOGRID.

SERPENTINE CURVES AND 90° RADIUS CORNER

DRAWN BY:
J. Johnson

APPROVED BY:

DATE:
01-07-10

SHEET NO. :
1 of 2

TITLE:

GEOGRID PLACEMENT
115 RETAINING

DRAWING FILE:
RS 115 Geogrid Placement on Curves 010710.dwg

REDI*SCAPES

05481 US 31 SOUTH CHARLEVOIX, MI 49720
866-222-8400 • 231-237-9521 Fax • www.redi-scapes.com

GEOGRID PLACEMENT FOR CONVEX CURVES AND CORNERS

SQUARED CORNER

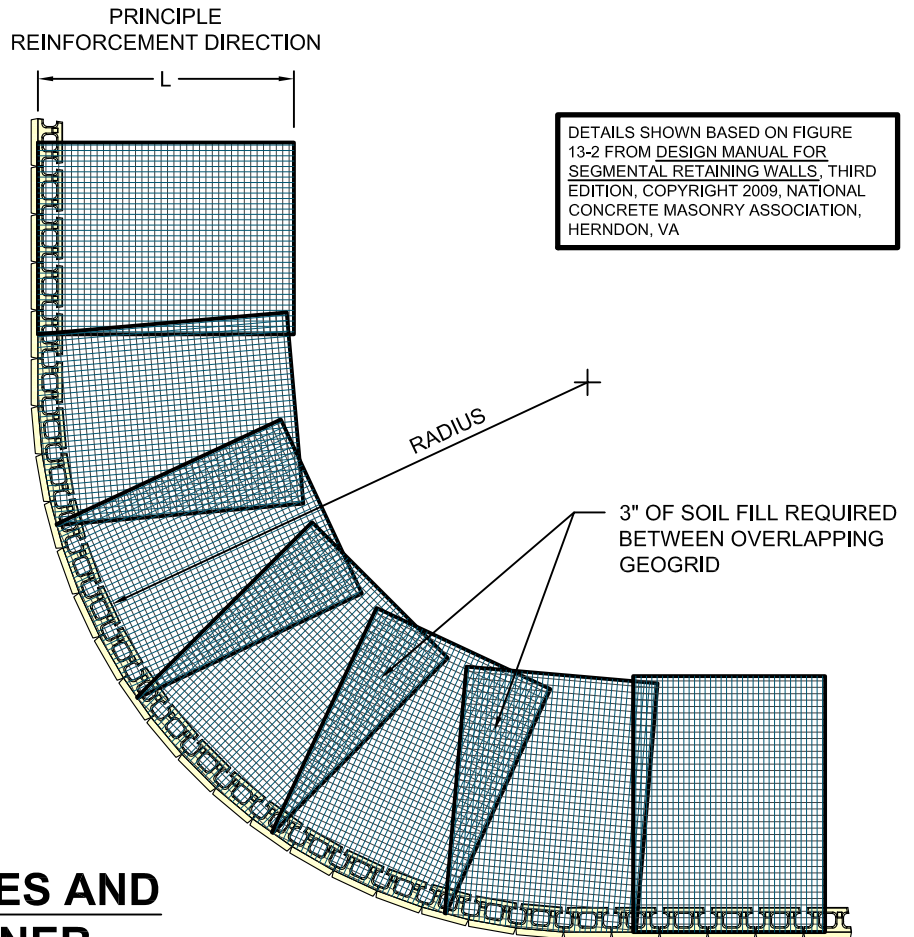
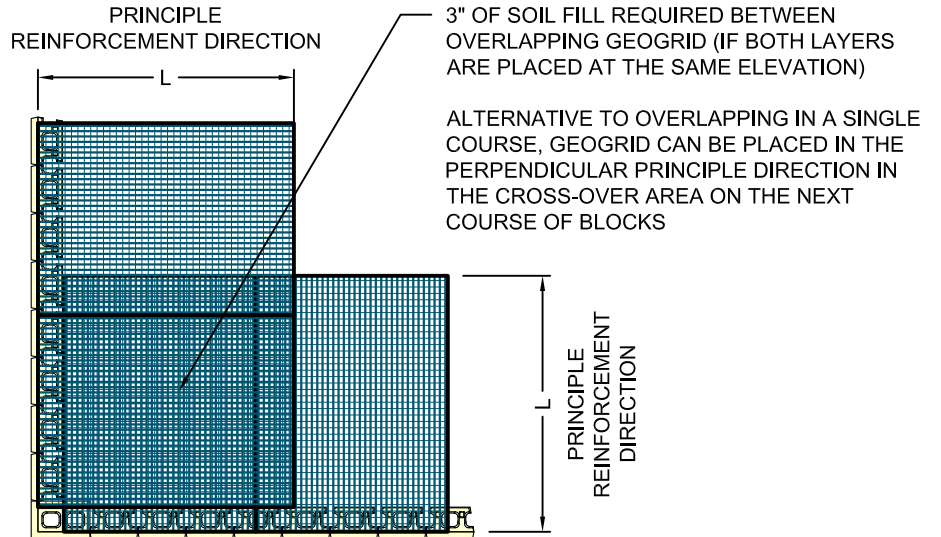

SERPENTINE CURVES AND 90° RADIUS CORNER

DRAWN BY:
J. Johnson

APPROVED BY:

DATE:
01-07-10

SHEET NO.:
2 of 2

TITLE:

GEOGRID PLACEMENT
115 RETAINING

DRAWING FILE:
RS 115 Geogrid Placement on Curves 010710.dwg

REDI-SCAPES

05481 US 31 SOUTH CHARLEVOIX, MI 49720
866-222-8400 • 231-237-9521 Fax • www.redi-scapes.com