

FREESTANDING WALL SECTIONS - 1 OF 2

UNREINFORCED WALL

20 psf (~90 mph) UNIFORM WIND LOAD

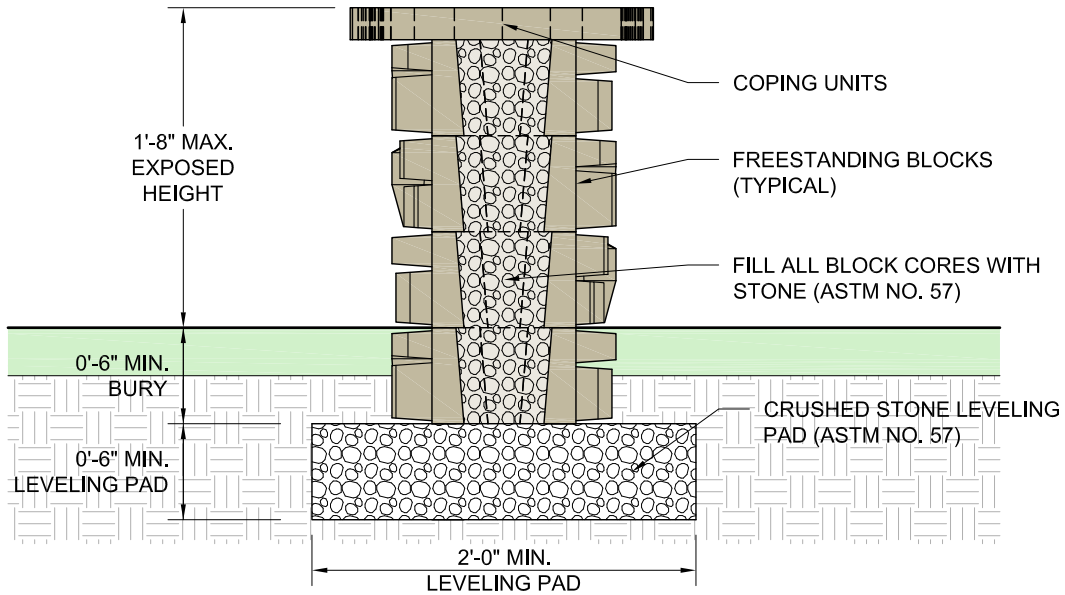

UNREINFORCED WALL

13 psf (~70 mph) UNIFORM WIND LOAD

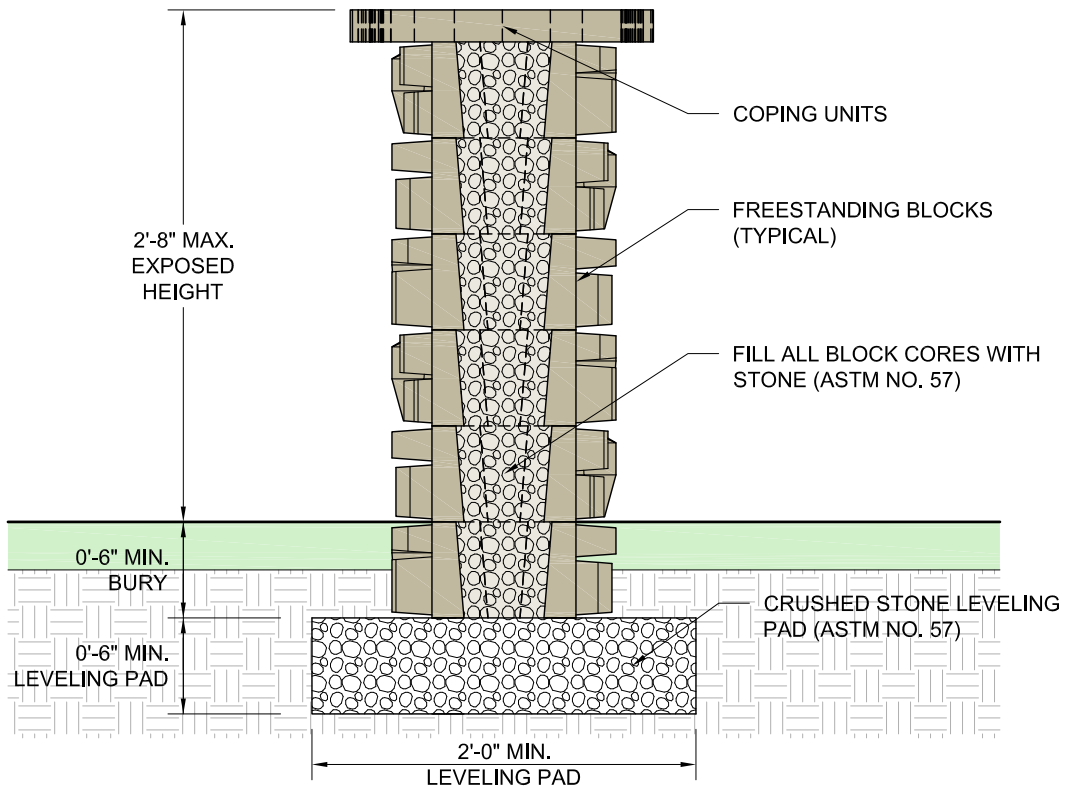

DRAWN BY:
J. Johnson

APPROVED BY:

DATE:
01-08-10

SHEET NO. :
1 of 2

TITLE:

FREESTANDING WALL OPTIONS
140 FREESTANDING

DRAWING FILE:
RS 140 Freestanding Section 010810.dwg

REDI*SCAPES

05481 US 31 SOUTH CHARLEVOIX, MI 49720
866-222-8400 • 231-237-9521 Fax • www.redi-scapes.com

FREESTANDING WALL SECTIONS - 2 OF 2

REINFORCED WALL

NOTE:

USE THE REINFORCED WALL SECTION FOR HIGHER FREESTANDING WALLS OR WALLS SUBJECT TO LARGER WIND OR APPLIED LOADS. REINFORCING STEEL AND CONCRETE LEVELING PAD ARE SIZED TO MEET PROJECT SPECIFIC REQUIREMENTS.

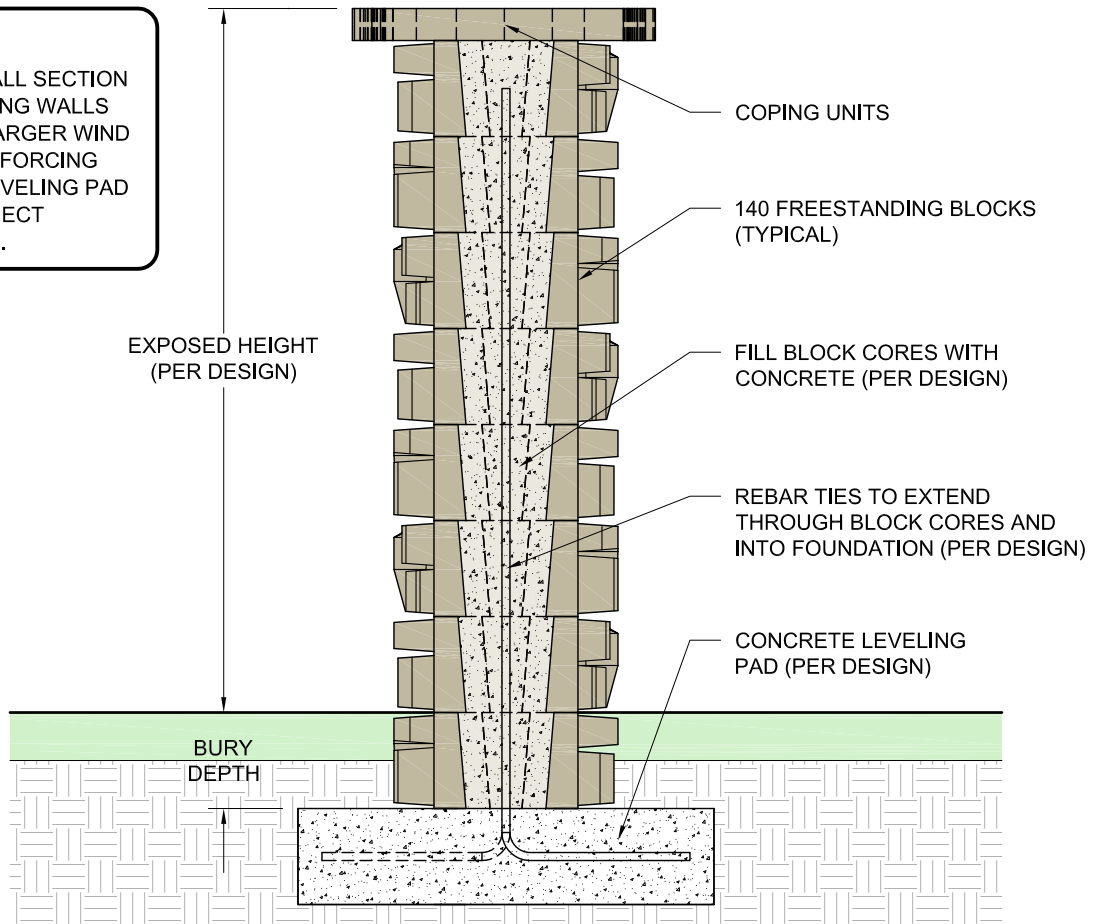

FREESTANDING WALL INSTALLATION NOTES

1. FOOTING EXCAVATION SHOULD BE TO THE DEPTH SHOWN IN THE ENGINEERED PLANS FOR THE WALL, BUT AT LEAST 6" BELOW THE ELEVATION OF THE BOTTOM BLOCK IN THE WALL.
2. FOOTING EXCAVATION WIDTH SHOULD BE A MINIMUM OF 24", WHICH WILL PROVIDE 6" ON EITHER SIDE OF THE BOTTOM BLOCK.
3. EXISTING SOIL SUB-GRADE SHOULD BE COMPACTED TO A MINIMUM OF 95% MAXIMUM DRY DENSITY BEFORE FOUNDATION MATERIAL IS INTRODUCED. SUB-GRADE SOIL SHOULD BE FIRM NATIVE SOIL, DRY AND STABLE. CONSULT A SOILS ENGINEER IF IN DOUBT.
4. PLACE LEVELING PAD MATERIAL AS SPECIFIED IN THE WALL DESIGN.
5. WALLS SHALL HAVE THE BOTTOM COURSE BURIED TO THE DEPTH SHOWN ON THE ENGINEERED DESIGN. A MINIMUM BURY OF 6" IS RECOMMENDED.
6. PLACE THE BOTTOM COURSE OF WALL BLOCKS. TAKE CARE TO LEVEL THE BLOCKS BOTH PARALLEL AND PERPENDICULAR TO THE WALL.
7. PLACE SUCCESSIVE UNITS TO THE DESIRED WALL HEIGHT.
8. FILL BLOCK CORES WITH STONE OR CONCRETE AS SPECIFIED IN THE DETAILED ENGINEERING PLANS. STEEL REINFORCEMENT, IF REQUIRED, MUST BE PLACED AS DETAILED IN THE WALL PLANS.
9. PLACE COPING UNITS TO FINISH THE WALL. COPING SHOULD ADHERE TO THE FREESTANDING BLOCKS WITH CONCRETE ADHESIVE OR OTHER MEANS AS SPECIFIED IN THE ENGINEERED WALL PLANS.

DRAWN BY:
J. Johnson

APPROVED BY:

DATE:
01-08-10

SHEET NO. :
2 of 2

TITLE:

FREESTANDING WALL OPTIONS
140 FREESTANDING

DRAWING FILE:
RS 140 Freestanding Section 010810.dwg

REDI*SCAPES

05481 US 31 SOUTH CHARLEVOIX, MI 49720
866-222-8400 • 231-237-9521 Fax • www.redi-scapes.com